

Brick slip lintels

B section range end bearing detail

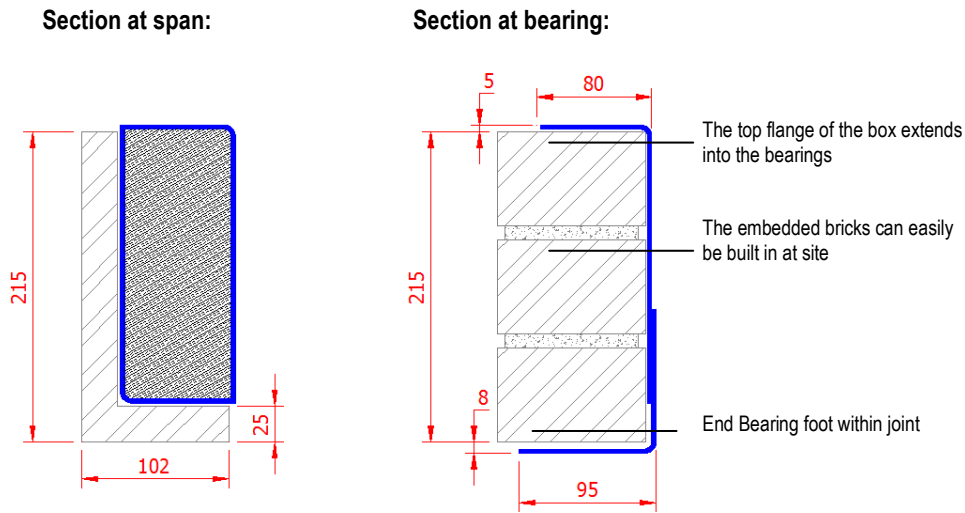

Stainless steel boxes are ideal to support brick slips. Fast, reliable, high load and low weight compared to the concrete alternative.

Our unique bearings allow site brickwork to be built butting the brick slip arch, this system gives both a high and low level bearing.

B 215/3, B290/3, B365/3 are heavy duty sections of C215/3, C290/3 and C365/3. Both C and B ranges suit soldier course or gauged brick arches. Slips are 25 mm as standard, 30 mm or other slip sizes can also be used.

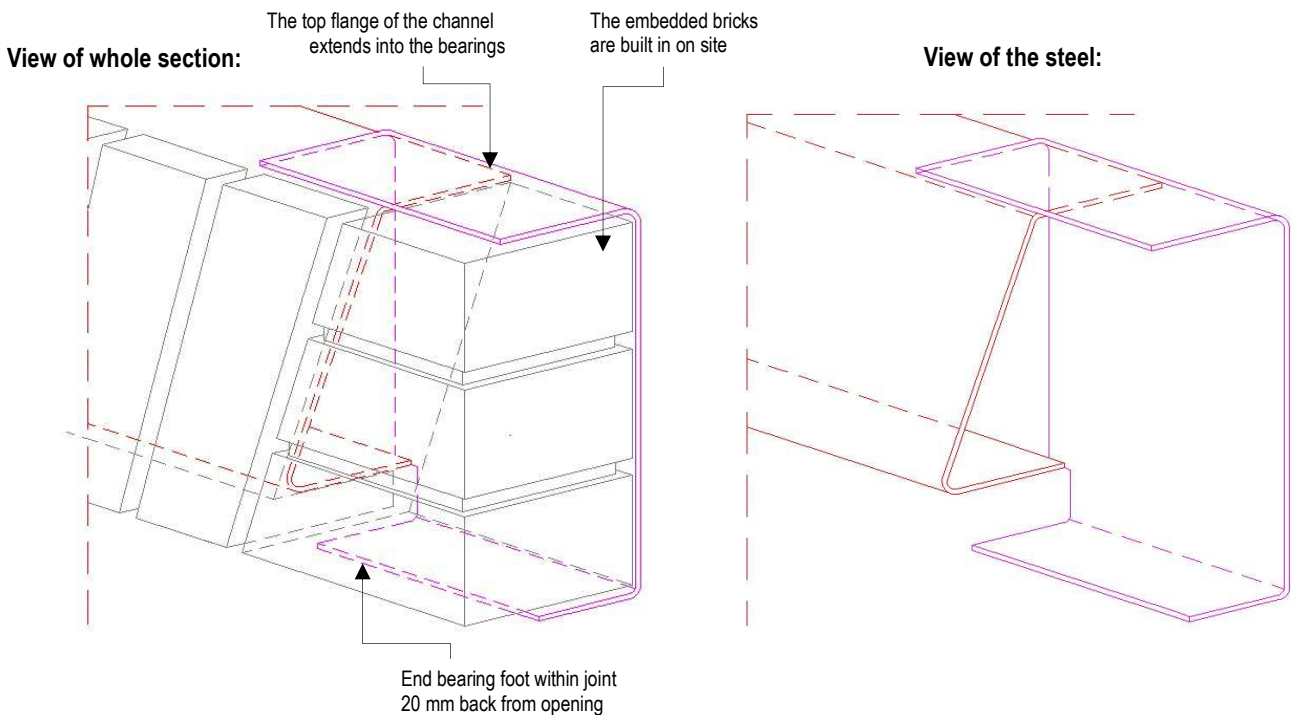

The section provides a bearing on the top flange with a second bearing at the "foot". Full bricks are laid up to the gauged brick eliminating the need for slips on site. Default material stainless steel SS370 (EN 1.4003) also available in stainless steel LDX2101 (EN 1.4162). Loadings are shown above to assist you in your selection 102.5mm brickwork is 2.2 kN/m². Dimensions can be varied to suit imperial, other brick sizes and thicker slips